

Wall mounting bracket series **ACQUAPIU'** "COMBI"

The carton marked *wall mounting bracket* contains the following

- a) Mounting bracket
- b) 3/4" cock for gas inlet (G)
- c) 3/4" cocks for c.h. flow (MR) and return (RR)
- d) 1/2" cock for d.h.w.inlet (ES) Blue
- e) 1/2" cock for d.h.w.outlet (US) Red
- f) 3/4" nuts for mounting 3/4" cocks (G), (MR), (RR)
- g) 1/2" nuts for mounting the 1/2" cocks (ES), (US)
- h) 1/2" connector nuts
- i) ø 22 mm o.d. pipes for c.h. flow, return and gas inlet with 3/4" connector nuts
- j) ø 15 mm o.d. pipes for d.h.w circuit
- k) 3/4" gaskets
- l) 1/2" gaskets

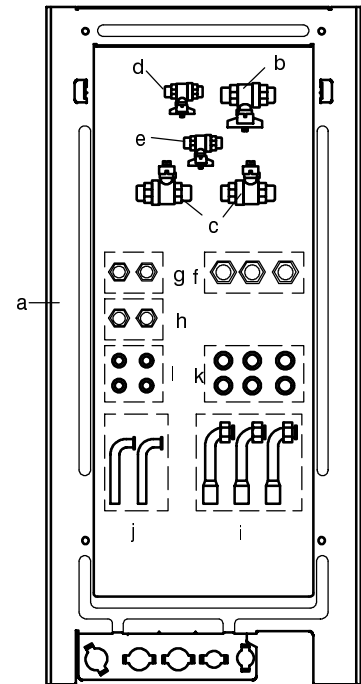

Measurements for installing the appliance

All measurements are in millimetres (inches in brackets)

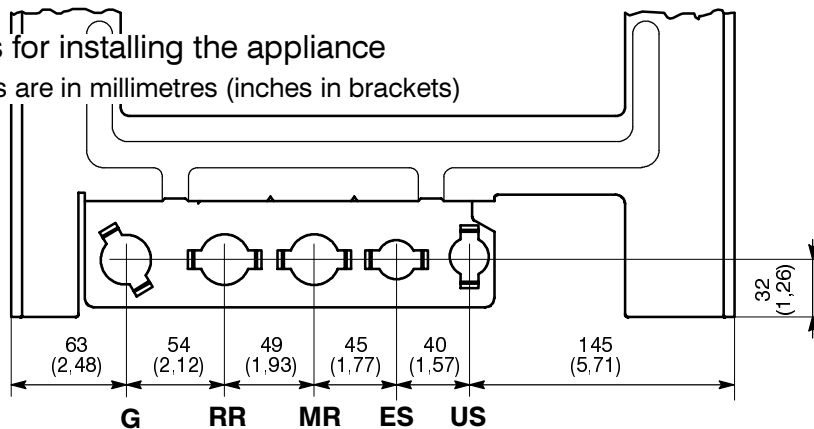

Mod. 120,124 ME

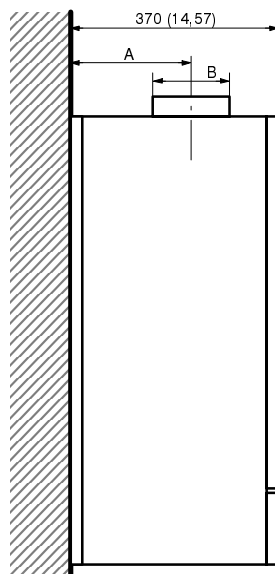
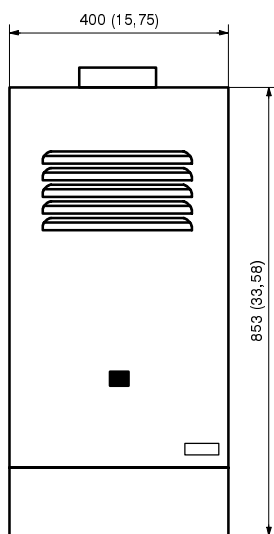

- A= 253 (9,96) for mod. 120
235 (9,25) for mod. 124
- B= ø 130 (5,12) for mod. 120
ø 140 (5,51) for mod. 124
- C= 190 (7,48) for mod. 120
178 (7,01) for mod. 124
- D= 206 (8,11) for mod. 120
218 (8,58) for mod. 124

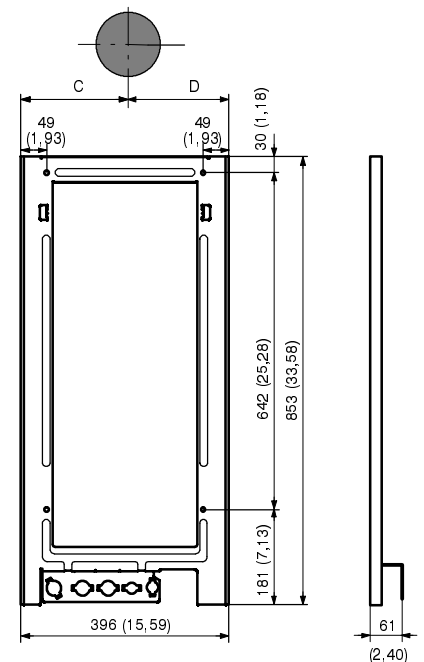

All measurements are in millimetres (inches in brackets)

Mod. 120,124 MFS (Measurements of the wall mounting bracket on the previous page)

mod. 120, 220 = 252
mod. 124, 224 = 227

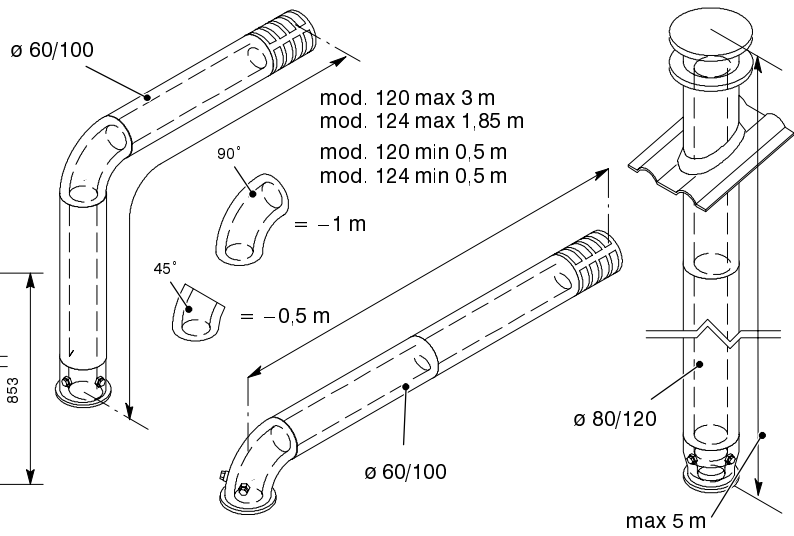
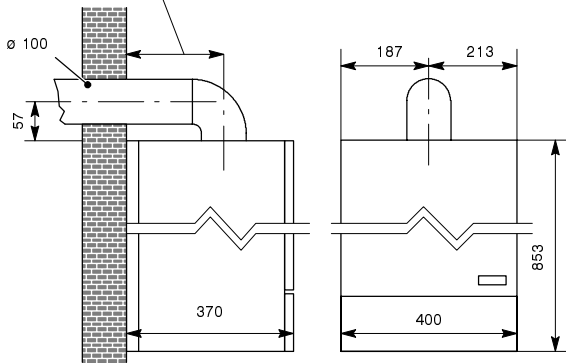

mod. 120, 220 = 252
mod. 124, 224 = 227

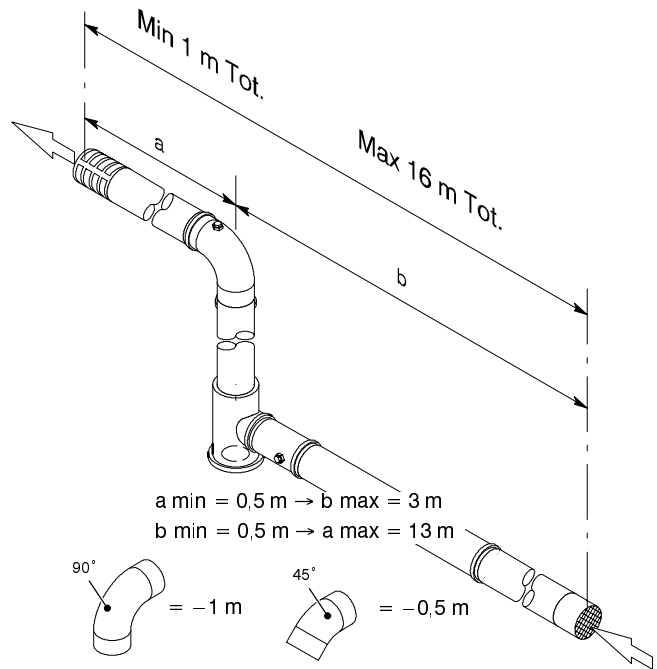
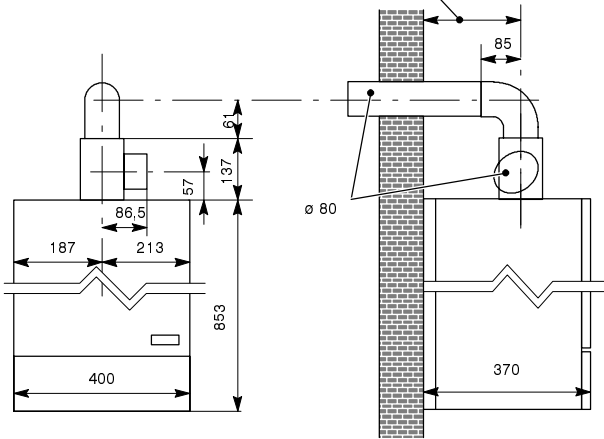

mod. 120, 220 = 252
mod. 124, 224 = 227

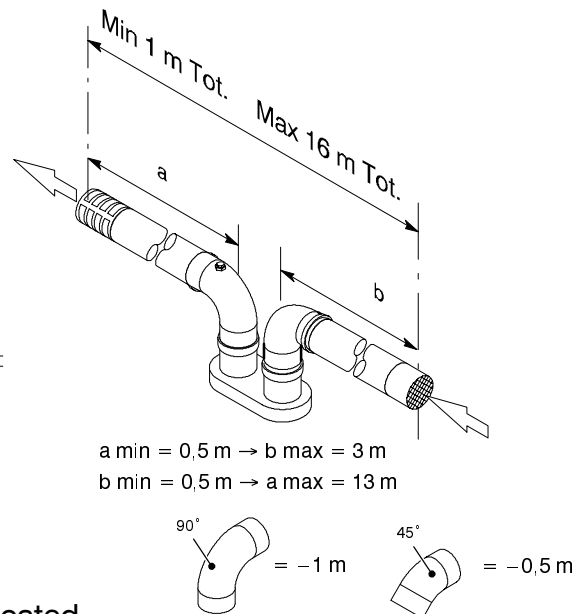
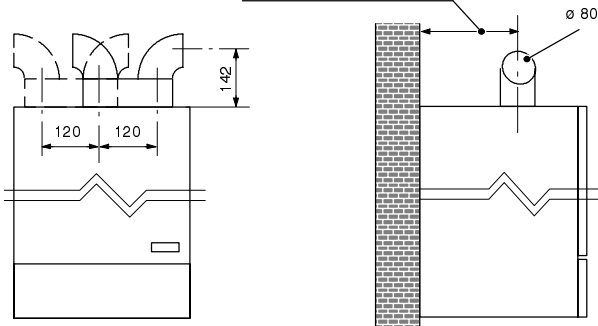

All the dimensions are in mm except where indicated.

Assembling the wall mounting bracket

- ❑ In order to permit adequate space for servicing, leave the clearances around the boiler following one of the three conditions shown.

I | a=400(15,75), b=50(1,97)
c=300(11,81), d=50(1,97)

II | a=200(7,87), b=50(1,97)
c=600(23,62), d=50(1,97)

III | a=200(7,87), b=130(5,12)
c=300(11,81), d=50(1,97)

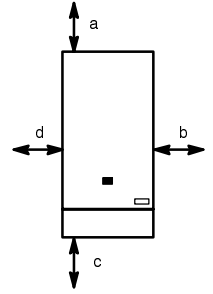

All measures are in millimetres (inches)

- ❑ Position the mounting bracket on the wall. Use a spirit level to make sure that the support is level;
- ❑ mark the attachment points through the holes indicated;
- ❑ remove the wall mounting bracket and drill holes in the wall at the points marked;
- ❑ use screws with wall plugs \varnothing 8 mm to attach the wall mounting bracket to wall;

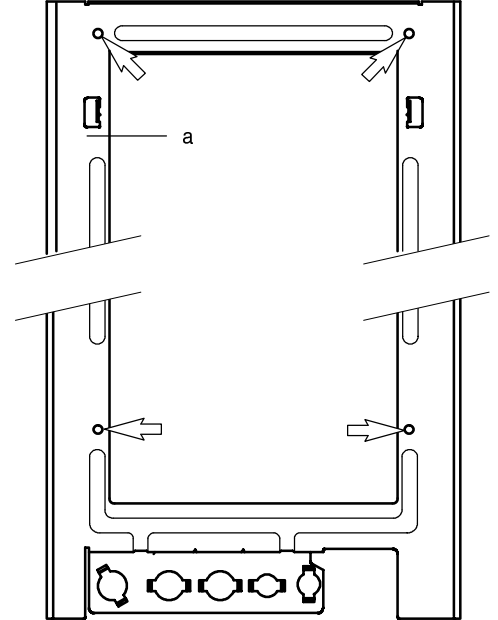

- ❑ mount the cocks and fittings on the bottom of the wall mounting bracket and tighten with the nuts. The d.h.w. outlet cock must be fitted with the inclination shown in the drawing.

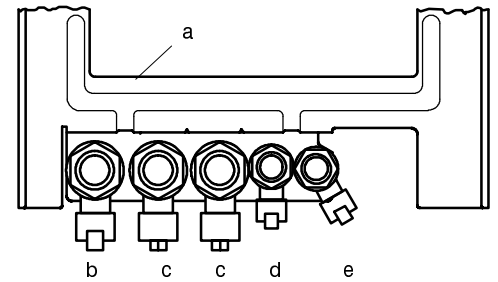

- ❑ use the connector nuts to connect the connecting pipes to their respective cocks. Be sure to use the correct gaskets when installing the pipes;
- ❑ the axis of the cocks must be perpendicular to the wall;
- ❑ complete the installation connecting the pipes to the other parts of the plant.

Check the soundness of the gas plant before mounting the boiler on the bracket.

Note: use the remaining gaskets to connect the boiler to the cocks.

